

GIZMO GZ1

SETUP SHEET

Driver: Cristian Tabush Date: 10/0916

Track: N Control RC - Dale, TX

Event: Soft Opening



Track Condition

Composition: Asphalt Carpet
Environment: Indoor Outdoor
Surface: Smooth Medium Bumpy
Traction: Low Medium High
Size: Tight Medium Open
Track Temp.: 120-140F **Air Temp.:** 90F

Electronics

Motor: Reedy 17.5 1S **Timing:** 48
ESC: HW V3.1 **Battery:** Protek 4350
Spur: 89 **Pinion:** 48 **Ratio:** 3.6

Aerodynamics

Body: Montech IS 200 **Wing:** Stock

Front	Shocks	Rear
<u>Axon 2.6</u>	- Spring -	<u>Axon 2.6</u>
<u>Axon 35</u>	- Oil -	<u>Axon 35</u>
<u>4x1.1</u>	- Piston -	<u>4x1.1</u>
<u>0</u>	- Rebound (%) -	<u>0</u>
<u>none</u>	- Foam Inserts -	<u>none</u>

Anti-Roll Bar

1.3 1.2

Tires

Sorex 36 Premount - Inserts - Sorex 36 Premount
 - Rims -
Ground FX - Additive - Ground FX
Air Dry - Additive Time - Air Dry

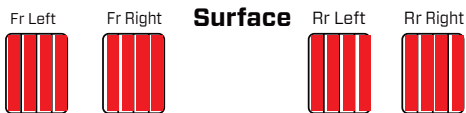

Transmission

Gear Ball - Diff - Gear Ball
 - Oil - Axon 5000
 - Oil Weight (Grs) -
 - Settings -
 Spool

Gizmo USA Short Towers with SLF
 2 Shocks
 Gizmo USA Aluminum Chassis

Front

Toe: 1.0 out
Camber: 2.25
Caster: 3
Droop: 2.5 ORH
Rideheight: 5
Wheel Hex: +0.5

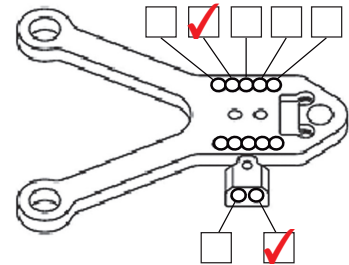
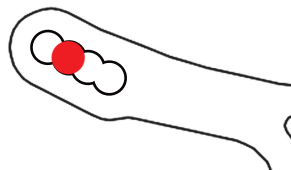
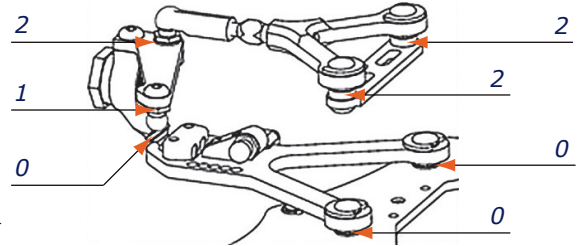

Rear

Toe: 2.5
Camber: 2.0
Caster: -2.0
Droop: 2.5 ORH
Rideheight: 5.5
Wheel Hex: 0

